

iWMD is a series of wireless measurement devices with high resolution. It allows the user to measure various sensor readings and communicate wirelessly with smart devices such as the iPad via Bluetooth Low Energy.

Applications:

- Remote Monitoring
- Power, Current & Voltage Monitoring
- Pressure Measurement
- Temperature Sensing (RTE, Thermocouple, Infrared)
- Crankshaft Deflection Detection
- Rotor Runout Assessment
- Wireless Metrology
- Flow measurement
- Oil characteristics sensing

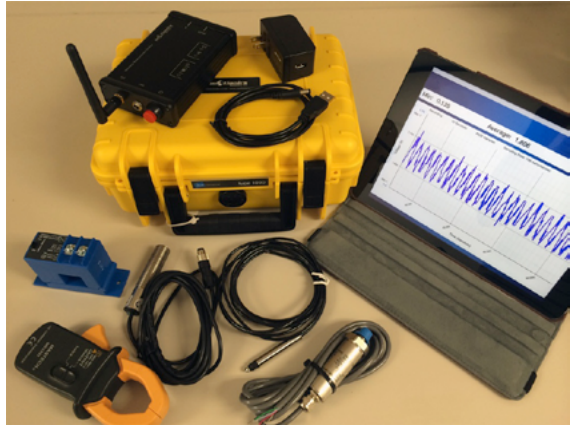

Current Measurement Kit	Specification
Resolution	10, 5, 1, 0.2, 0.1 mV
Wireless Data Rate	1-1,000 Hz
Transmission Range	Up to 10 m
Input Range	0 - 10, 0 - 5, 0 - 1.1 VDC
Dimension	5.04 x 3.07 x 1.06 in
Sensor Supply Voltage	5-20 VDC
Antenna Extension	Magnetic Base
Working Temperature	0 - 50 °C
Battery	2,500 mAh
Charging	5 VDC USB and 110 VAC

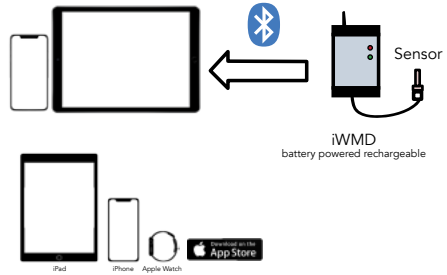

App Features:

- Multiple wireless sensor connectivity
- Display acquired data in real-time graph
- Record data, CSV and SQLite export
- Quick custom PDF report with image, signature, map and GPS location
- Export via email, cloud, and USB cable
- Zoom, pan, max, min, and average

